

# TIDY TRACK®

## TRACK PAINTER - RUSTY RAIL TT4581



### INSTRUCTIONS / INSTRUCTIONS / INSTRUCCIONES / ANWEISUNGEN

Use Track Painters before or after installation to model track that looks as realistic as the rest of the layout. Track Painters work for all scales and can be used on metal or plastic.

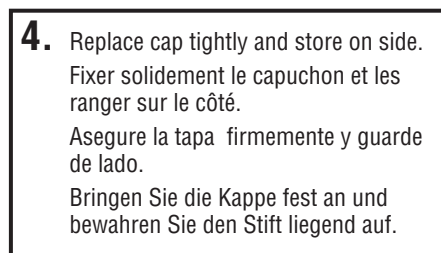
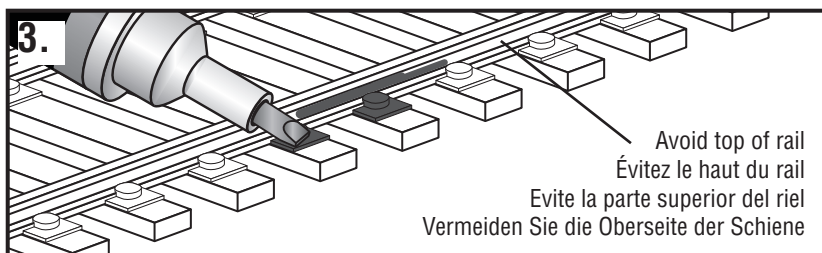
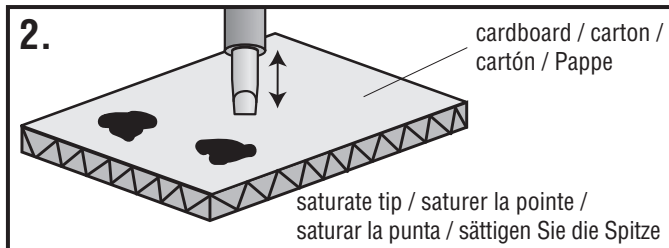

**5.** If paint dries on top of rails, remove using Maintenance Pads (TT4552) or light grey side of Rail Pal™ (TT4575). Dried paint on top of rails will inhibit conduction. Si la peinture sèche sur rails, enlever à l'aide de Maintenance Pads (TT4552) ou la lumière côté gris de Rail Pal (TT4575). La peinture sèche sur rails va inhiber la conduction. Si la pintura se seca encima de los railes, quitarla usando Maintenance Pads (TT4552) o el lado gris claro de Rail Pal (TT4575). La pintura seca encima de los railes inhibirá la conducción. Falls die Farbe auf der Gleisoberseite eintrocknet, entfernen Sie diese mit den Maintenance Pads (TT4552) oder der hellgrauen Seite der Rail Pal (TT4575). Auf dem Gleis eingetrocknete Farbe verhindert die elektrische Leitfähigkeit.

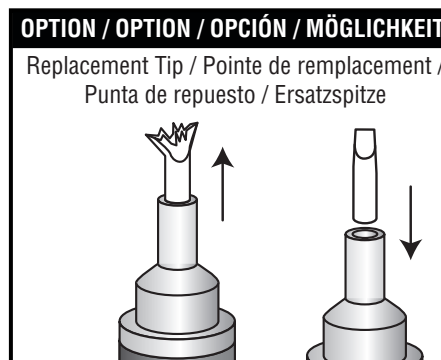

Conforms to Health Requirements of ASTM D4236

Model making product. Not a toy! Not suitable for children under 14 years! / Produit pour le modélisme. Pas un jouet! Pas adapté aux enfants de moins de 14 ans! / Producto para modelismo. No es un juguete! No adecuado para niños menores de 14 años! / Modellbauartikel. Kein Spielzeug! Nicht geeignet für Kinder unter 14!